

CHOICE PRO



JUVOUS

www.juvous.com

User Manual

Please read these instructions carefully before using your JUVOUS device, and keep this user guide for future reference.

Safety Warnings

THIS PRODUCT CONTAINS NICOTINE, A HIGHLY ADDICTIVE SUBSTANCE. NOT TO BE USED BY NON-SMOKERS. THIS PRODUCT MAY POSE HEALTH RISKS. KEEP OUT OF REACH OF CHILDREN AND PETS.

Avoid direct contact with eyes, skin, or mouth. If contact occurs, thoroughly rinse the affected area with water. If accidentally ingested, rinse your mouth thoroughly and avoid swallowing.

IF SWALLOWED: Immediately contact a POISON CENTRE or seek medical advice:

•NZ: 0800 764 766
•AU: 131 126

If you feel unwell after using this product, stop use immediately and seek medical advice.

Store in a cool, dry place, away from direct sunlight.

Not Suitable For:

Persons under 18 years of age.
Persons allergic or sensitive to nicotine.
Pregnant or breastfeeding women.
Persons advised to avoid nicotine products for medical reasons.
Persons with heart disease, hypertension, or diabetes.

Child Lock and Removable Battery:

This device is equipped with essential safety features, including a Child Lock Function to prevent unauthorized or accidental use, and a Removable Battery designed for convenience while adhering to the highest safety standards.

PRODUCT STORAGE

To ensure the safety and performance of your JUVOUS device, follow these storage guidelines:
• Store in a cool and dry environment, away from household chemicals and direct sunlight.
• Avoid excessive heat: High temperatures can damage the battery, leading to malfunction, fire, explosion, or release of harmful substances.
• Keep out of children's reach and sight.
• Do not store the device in a sub-freezing environment (e.g., freezer).

BEFORE USE

Before first use, please remove the protective sticker from the bottom of the pod and pull out the silicone plug.

RECYCLING AND DISPOSAL

The JUVOUS vape device is considered electronic equipment. Electronic equipment should not be disposed with other household wastes. It is your responsibility to dispose of your electronic equipment separately from the municipal waste stream. Please drop off your electronic waste at your local waste and recycling depot. Never toss the device into fire which might cause battery burst or explode. Be sure that the used device cannot be pulled out of the trash by a child. Used devices can still pose health risks and cause serious or fatal injuries.

REMOVE THE BATTERY

To safely remove the battery from the device, follow these steps:
a. Locate the screw at the bottom of the device (refer to the diagram).

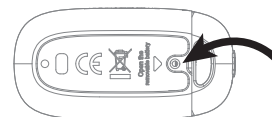

b. Use a screwdriver to loosen and remove the screw.
c. Remove the side cover panel to access the battery compartment.
d. Carefully extract the battery from the compartment.
e. Gently remove the battery from the battery compartment.

Note

• Dispose of the battery according to local regulations.
• Handle the battery carefully to avoid damage or accidents.

CONTACT US

We are always here to help.
Info@juvous.com
www.juvous.com

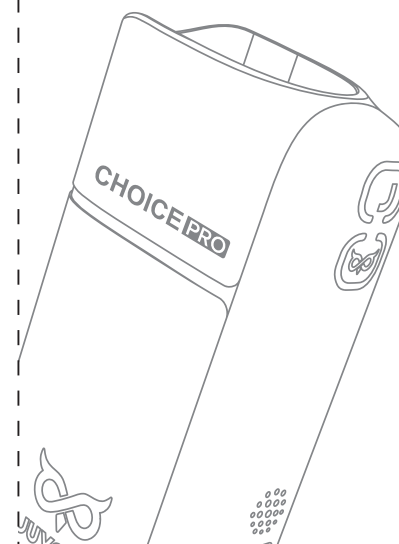

1. UI EFFECT DISPLAY

① Dual Tank

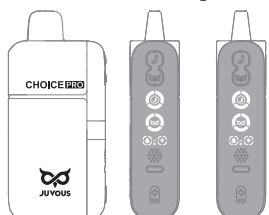

2. Lock/Unlock

When locked:
Press the button (L), and the child-lock icon will flash. Press the button 5 times quickly to unlock the device.

When unlocked:
The child-lock icon disappears from the screen. Press the side button (R) 5 times quickly to lock the device again.

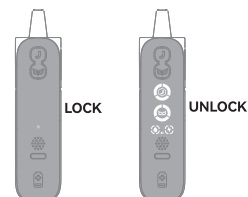

Auto-lock:

If the device remains unused for 10 minutes, it will automatically lock. Passive light interactions do not count as user actions.

3. Power Level Adjustment

① Dual Tank Mode

Press either button once to wake the screen. Press (L) again to cycle through power levels. The number of bars (L) displayed corresponds to Level 1, 2, or 3.

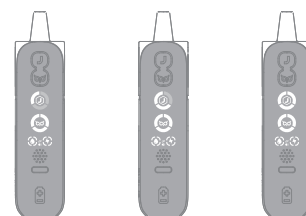

Press either button once to wake the screen. Press (L) again to cycle through power levels. The number of bars (L) displayed corresponds to Level 1, 2, or 3.

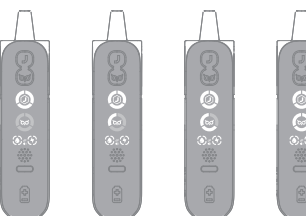

4. Sound effect

With the screen on, press and hold the button (L), then press (L) once more to enter sound settings. Press the button (L) repeatedly to switch between Inhale Sound 1, Inhale Sound 2, and Sound Off. A preview will play for each selection. To save your choice, either start inhaling or wait for the screen to turn off.

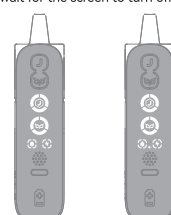

5. Logo Light On/Off

With the screen on, press and hold the button (L), then press (L) 4 times to turn the Logo light on or off. The Logo light will flash white once as confirmation.

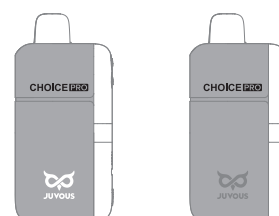

6. Screen On/Off

With the screen on, press and hold the button (L), then press (L) 3 times to turn the screen on or off. When the action is successful, the screen will turn off or light up immediately.

7. Logo Interaction Light On/Off

With the screen on, press and hold the button (L), then press (L) 2 times to turn the Logo interaction light feature on or off. When the feature is enabled, an icon (L) will appear on the screen. If no icon (L) is shown, the interaction feature is off.

8. Sound Effect

① Startup Sound (On/Off)
Speaker Icon Off: The startup sound is disabled. Your device will power on silently.
Speaker Icon On: The startup sound is enabled. A sound will play when you turn on the device.

② Inhale Sound (On/Off)
Speaker Icon Off: The inhale sound is disabled. There will be no sound when you vape.
Speaker Icon On: The inhale sound is enabled. A sound will play as you inhale.

9. Inhale Light Effects

When Logo Light is ON:
As you inhale, the front Logo displays a white breathing light. After you stop, this breathing effect continues for 1.5 seconds, transitions to a static white light for another 1.5 seconds, and then turns off.

When Logo Light & Interaction are BOTH ON:
As you inhale, the Logo shows a special interaction sequence: 3 rapid white flashes within one second, followed by a 4-second RGB color cycle, and finally a 1.5-second static white light before turning off.

When Logo Light is OFF:
The front Logo will show no light effects when you inhale.

Screen Light Effects
When Screen Light is ON:
After you stop inhaling, the side screen light will fade out after a 3-second delay.

When Screen Light is OFF:
The screen will remain off during all operations, including inhaling.

10. Interaction Mode

How to Trigger an Interaction:
When both the Logo Light and the Interaction Feature are enabled, inhaling for 2.5 seconds will send out an interaction signal to compatible devices within a 10-metre range.

What a Successful Interaction Looks Like:
Both the initiating and receiving devices will display a special light sequence on their front Logos: 3 rapid white flashes (within 1 second)+4-second RGB color cycle+ 1.5-second static white light. The screen then turns off.

Important Notes:

Requirements for Interaction:
To send or receive an interaction, both the Logo Light and Interaction Feature must be enabled on your device. The receiving device must be powered on, unlocked, and not currently in use (e.g., not being inhaled from or operated).

During an Interaction:

A device in an active interaction cannot be interrupted by other signals. Once the sequence is complete, the device can send or receive another interaction signal.

How to Interrupt an Interaction:
If your device is receiving an interaction, you can stop the light effect at any time by inhaling, re-inserting the pod, or pressing any button once.

11. E-liquid Level Display

When the e-liquid level drops to the final bar (25% remaining), a low e-liquid warning is triggered. The last white bar will flash to alert you.



12. Battery Level Display

When the battery level drops to the final bar (25% remaining), a low battery warning is triggered. The last white bar will flash to alert you.



13. Battery Level Display

While charging, the lightning icon will flash continuously. It will stop flashing once the battery is fully charged.

